

# TELEX®

# SAFE-1000 UHF

ENCRYPTED WIRELESS MICROPHONE SYSTEM

DIGITAL  
ENCRYPTION

UHF  
AGILE

950  
CHANNELS

UP TO  
16+  
SIMULTANEOUS  
SYSTEMS

## Who's listening to your conversation?

While the wonders of wireless technology brought new freedom to communication, your conversations were available to whoever wanted to listen.

***Until now.***



THE S.A.F.E.-1000 WIRELESS MICROPHONE SYSTEM is available with a beltpack transmitter or a handheld microphone. The rugged cast magnesium beltpack transmitter is a compact design that meets the needs of most any wireless user. The handheld microphone is fully featured and includes a unique warmgrip™ handle.

So when the application calls for security, S.A.F.E.-1000 is the solution.

## SECURE AUDIO FREQUENCY ENCRYPTION

**NOW TELEX, CREATORS OF THE FIRST SECURE WIRELESS MICROPHONE, OFFERS FREEDOM AND SECURITY** with the new S.A.F.E.-1000™ second generation encrypted wireless microphone system. The S.A.F.E.-1000 (Secure Audio Frequency Encryption) system brings airtight security to wireless transmissions of confidential information. Each and every matched S.A.F.E.-1000 system comes with its own unique security code. Not even another S.A.F.E.-1000 receiver can intercept your transmission.

**THE S.A.F.E.-1000 OFFERS POWERFUL FEATURES** like Advanced ClearScan™ automatic channel selections, 950 possible channels, and factory preset groups and channels that allow up to 16 simultaneous systems in one band. These tools make setting up a Fortune® 500 boardroom with 10 systems quick and easy.

**WHEN CONFIDENTIALITY IS PRIORITY ONE, THE S.A.F.E. SYSTEM REPRESENTS A BREAKTHROUGH IN SECURITY FOR WIRELESS MICROPHONES.** Based on technology adapted from Telex's intercom used by the National Football League, the S.A.F.E.-1000 system is ideal for the transmission of restricted or classified information over a wireless system. A scanner cannot intercept encrypted conversation when you're on a S.A.F.E.-1000 system, unlike other brands of wireless microphones.

## SPECIFICATIONS

### SAFE-1000 Receiver

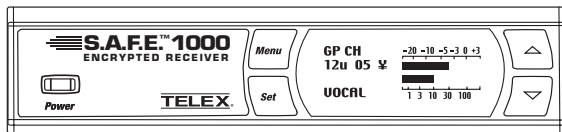

FRONT PANEL

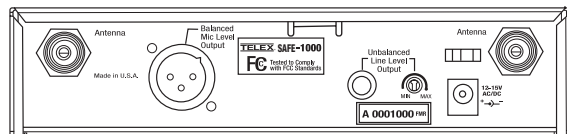

REAR PANEL

#### Controls

Front Panel:	On/Off, menu, set, up, down buttons
Rear Panel:	1/4 inch output level

#### Indicators

LCD Backlit Display:	Group, channel, diversity, label, squelch, set-up screen, audio signal amplitude, RF signal strength.
----------------------	---

#### Connectors

Back Panel:	1/4 inch unbalanced adjustable output XLR balanced output
Antennas:	Detachable 1/4 wave

#### RF Specifications

Frequency Range:	A Band 680 – 704 MHz (TV Channels 49, 50, 51, 52) B Band 722 – 746 MHz (TV Channels 56, 57, 58, 59)
Number of Channels:	950 possible (programmable in 25kHz steps)
Diversity:	DSP PosiPhase true diversity
Receiver Type:	synthesized PLL agile UHF
Modulation Type:	NFSK
Squelch:	Digital plus Amplitude
FCC:	Approved under Part 15

#### Audio Specifications

Frequency Response:	100 – 7000 Hz +/- 2 dB
Encryption:	32 Bit (16 imbedded, 16 user assigned)
Audio Output Level:	
Line Level	8 mV - 0.775V RMS into a 100 k ohm load
Balanced	-10 dBV max
Distortion:	Less than 1.0% (@1kHz)
Signal to Noise Ratio:	> 90 dB
Dynamic Range:	>90 dB

#### General Specifications

Power Supply:	External 12 VAC 750mA in-line with cord
Size:	1.72" H x 7.50" W x 8.38" D 43.69mm H x 190.50mm W x 212.85mm D
US Patent No.:	4,293,955

### SAFE-HT Handheld Transmitter

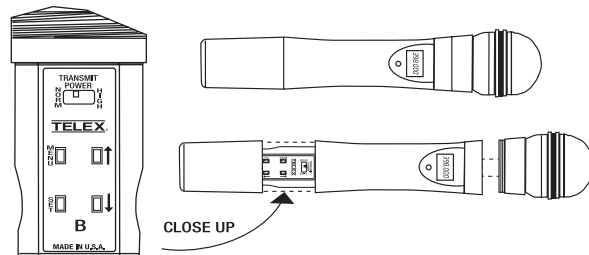

#### Controls

Power on/off
Audio gain adjustment with 26 dB range
Transmit power switch
Menu, set, up, down buttons

#### Displays

LCD display (channel and group, frequency, battery level), red LED battery low indicator
--

#### Battery Life

7 hours with 9V alkaline (typical)
------------------------------------

#### Antenna

Internal 1/2 wave
-------------------

#### Microphone Elements

EV N/D 767a Dynamic or RE 510 Condenser (Available separately)
--

#### RF Output

Normal	5 mW (typical)
High	50 mW (typical)

#### Size

10.5 in. long (26.8 cm)
-------------------------

### SAFE-WT Bodypack Transmitter

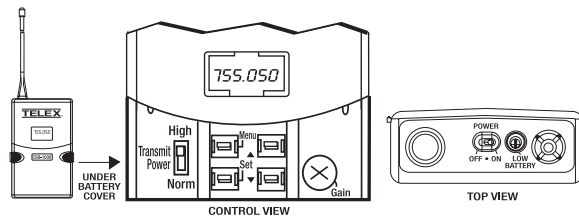

#### Controls

Power on/off switch
Audio gain adjustment with 40 dB range
Transmit power switch
Menu, set, up, down buttons

#### Indicators

Red LED low battery indicator
LCD display (channel/group, frequency, battery level)

#### Battery Life

7 hours with 9V alkaline (typical)
------------------------------------

#### Antenna

External 1/4 wave detachable
------------------------------

#### Connector

TA4M input for microphone
Pin 1 ground, pin 2 mic input
Pin 3 +5V bias, pin 4 +5V through 3k ohm

#### RF Output

Normal	5 mW (typical)
High	50 mW (typical)

#### Case Material

Cast magnesium
----------------

#### Size

3.75 in. x 2.6 in. x .9 in.
96 mm x 66 mm x 23 mm